

AT-8
CLAMP CYLINDER DETAIL 1 OF 2

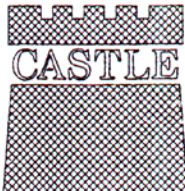
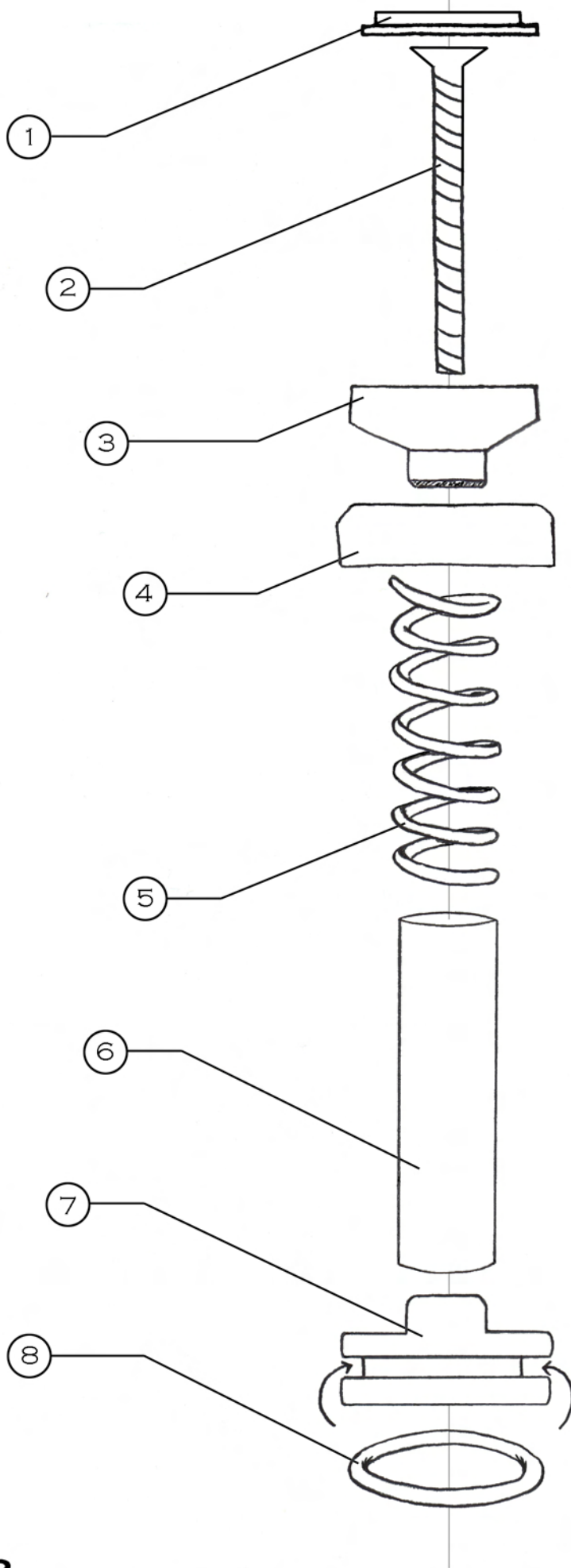

AT-8
CYLINDER PISTON DETAIL 2 OF 2

DRAWING 1 OF 2 - CLAMP CYLINDER DETAIL

Item #	Part #	Part Description	Qty
1		Cylinder Piston Assembly	
2	D15800	Internal Retaining Ring, 1-5/8	2
3	G08006	AT Cylinder Sleeve	1
4	F10377	Screw, Machine 10-32 x 7/8 PPMS	1
5	M08615	AT Stainless Steel Washer	1
6	G00051	AT Reinforced Neoprene Rubber Gasket	1
7	G08001	AT Air Cylinder Channel	1
8	F80122	Screw, Phillip Pan Sheet Metal 8 x 1/2	1
9	F10338	Screw, Machine 10-32 x 3/8 PPMS	1
10	F32012	AT Pem Stand-Off	1
11	F10000	# 10 SAE Flat Washer - 90126A11	1
12	G08242	Wear Strip, 1-1/4 UHMW	6
13	H51608	Vibration Mount, SE Rubber 5/16-18	1
14	F51699	Locknut, Nylon 5/16-18	1

Item #	Part #	Part Description	Qty
15	G08002	AT Air Cylinder Valve Lever	1
16	F14114	Locknut, Brass 1/4 NPT	1
17	H00352	Buna-N O-Ring - 003	1
18	N08001	AT Valve Piston	1
19	H00600	Buna-N O-Ring - 006	1
20	P12447	Swivel Elbow, 1/4M x 5/32	1

DRAWING 2 OF 2 - CYLINDER PISTON DETAIL

Page 2

Item #	Part #	Part Description	Qty
1	N70118	Poly Foot Pad, 1 x 1/8, AA70NA Button	1
2	F14204	Screw, Machine 1/4-20 x 4 PFMS	1
3	N08005	AT Cylinder Foot	1
4	N08011	AT Air Cylinder Ring	1

Item #	Part #	Part Description	Qty
5	H11135	AT Cylinder Return Spring	1
6	O08075	AT Cylinder Piston Rod	1
7	N08010	AT Air Cylinder Piston	1
8	H32200	Buna-N O-Ring - 322	1